

**GENERAL NOTES**

- (1) ALL DISTANCES (RECORD) = MEASURED, UNLESS OTHERWISE NOTED.
- (2) IT IS THE RESPONSIBILITY OF THE CONTRACTOR TO HAVE ALL THE UTILITIES MARKED BY THE RESPECTIVE UTILITY COMPANY PRIOR TO CONSTRUCTION.
- (3) PRIOR TO ANY DIGGING, CALL U.S.A. (1-800-642-2444) AT LEAST 48 HOURS IN ADVANCE TO HAVE EXISTING UNDERGROUND UTILITIES MARKED.
- (4) GROUND CONDITIONS SHOWN HEREON REFLECT CONDITIONS ON THE DATE OF THE SURVEY.
- (5) CONSULTANT IS NOT RESPONSIBLE FOR AREAS MARKED AS "HEAVY BRUSH."
- (6) THIS MAP WAS PREPARED FOR THE EXCLUSIVE USE OF THE MUIR BEACH COMMUNITY SERVICE DISTRICT AND THEIR ARCHITECT/ENGINEER, USE BY ANY OTHER PARTY FOR ANY PURPOSE WHATSOEVER IS PROHIBITED.
- (7) THIS IS NOT A BOUNDARY SURVEY.
- (8) TREES WERE LOCATED BY ESTIMATING THE CENTER OF THE TREE WHERE IT ENTERS THE GROUND AND IDENTIFYING THE DIAMETER AT BREAST HEIGHT. TREE TYPES MAY BE VERIFIED BY A CERTIFIED ARBORIST, IF NECESSARY.
- (9) ONLY ACCESSIBLE SURFACE UTILITIES VISIBLE ON THE DATE OF THIS SURVEY ARE SHOWN. THIS SURVEY DOES NOT SHOW THE LOCATION OF, OR ENCROACHMENTS BY, SUBSURFACE UTILITIES, FOOTINGS, FOUNDATIONS AND/OR BASEMENTS OF BUILDINGS. ALL USERS ARE ADVISED TO CONTRACT SEPARATELY WITH AN UNDERGROUND UTILITY LOCATION COMPANY AND TO REVIEW PUBLIC, QUASI-PUBLIC AND GIS UTILITY DATA SOURCES IF THEY WANT MORE INFORMATION.

**BASIS OF ELEVATION**

ELEVATION IS ASSUMED. CONTROL POINT #1 A 60D NAIL SET IN THE SOUTHEASTERLY SIDE OF THE ROAD 4.5 FEET EAST OF THE EDGE OF PAVEMENT AND 30 SOUTHERLY FROM THE TOP OF STAIRS  
ELEVATION = 500.00'  
CONTOUR INTERVALS = 2.00'

**BOUNDARY NOTE:**

THE APPROXIMATE LOT LINES SHOWN HEREON ARE FROM RECORD MAP INFORMATION AND DOES NOT CONSTITUTE A BOUNDARY SURVEY. THIS DEPICTION IS SOLELY FOR REFERENCE

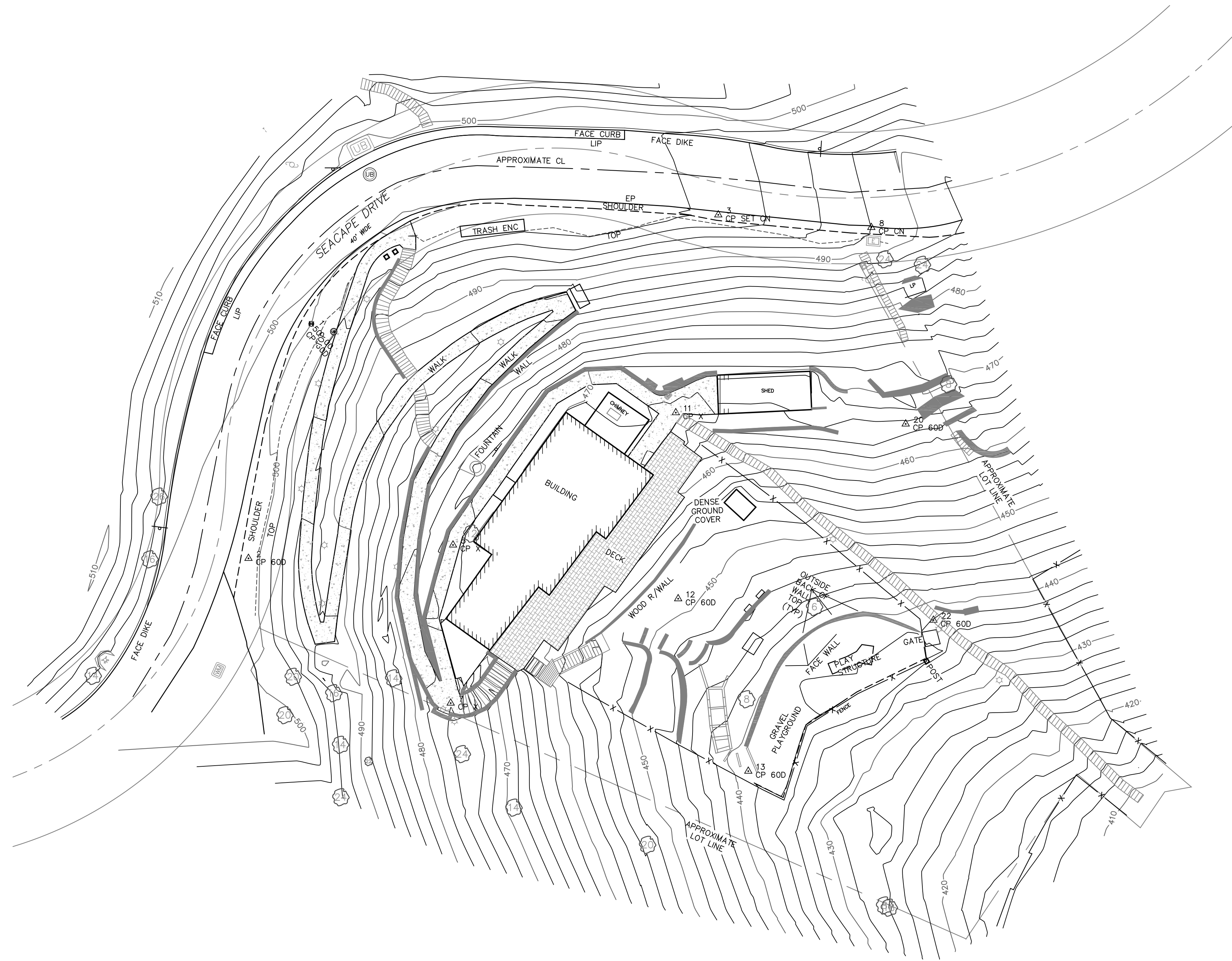
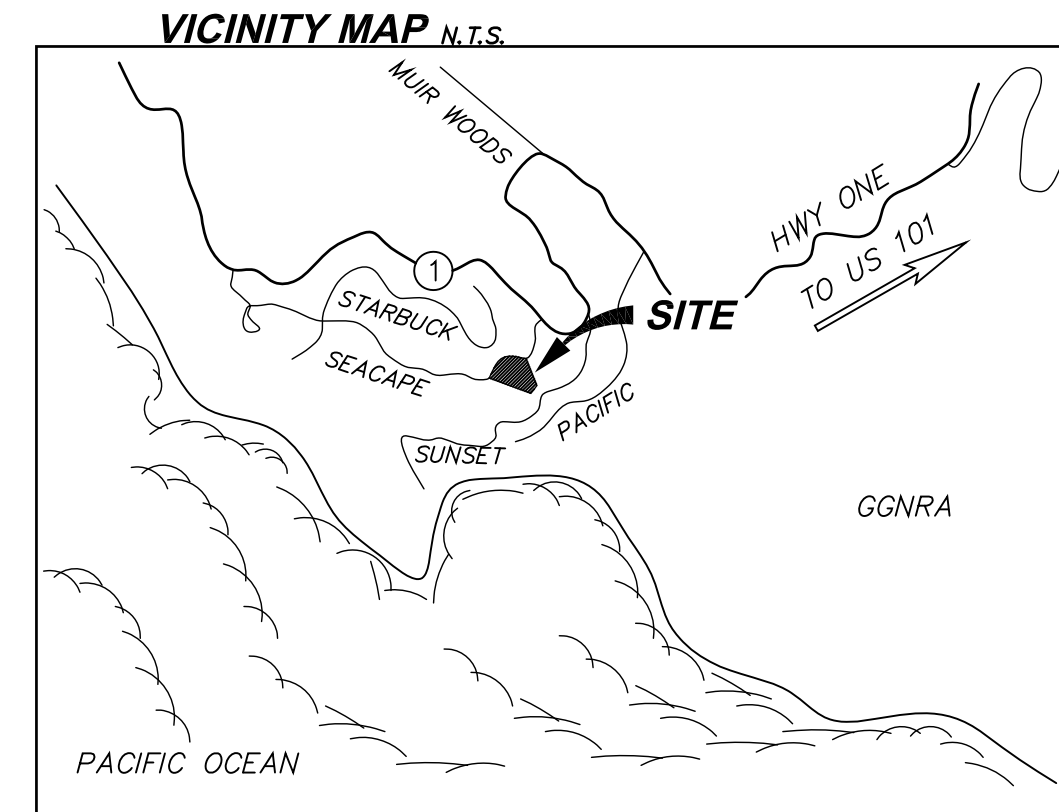

**LEGEND**

|                    |                    |
|--------------------|--------------------|
| CL                 | CENTERLINE         |
| EP                 | EDGE OF PAVEMENT   |
| FF                 | FINISHED FLOOR     |
| (TYP.)             | TYPICAL            |
| VLT                | VAULT              |
| ---                | CENTERLINE         |
| -x-x-              | FENCE              |
| (circle with X)    | UTILITY BOX ROUND  |
| (square with X)    | ELECTRIC BOX       |
| (circle with X)    | TELEPHONE BOX      |
| (triangle with X)  | CONTROL POINT      |
| (square with X)    | UTILITY POLE       |
| (circle with X)    | TREE SYMBOL W/SIZE |
| (square with X)    | SIGN/SIGN POST     |
| (circle with X)    | LIGHTPOLE          |
| X XXX.XX           | SPOT ELEVATION     |
| (circle with X)    | WATER METER        |
| (rectangle with X) | WALL               |
| (rectangle with X) | STEPS              |

**PARTIAL SITE SURVEY**  
LANDS OF MUIR BEACH COMMUNITY SERVICE DISTRICT  
PREPARED FOR THE COMMUNITY OF MUIR BEACH

MARIN COUNTY CALIFORNIA  
AUGUST 2013



**MERIDIAN SURVEYING ENGINEERING, INC.**  
2958 VAN NESS AVENUE SAN FRANCISCO, CA 94109 (415) 440-4131  
777 GRAND AVENUE, #202 SAN RAFAEL, CA 94901 (415) 456-5450

|              |            |                |            |
|--------------|------------|----------------|------------|
| DRAWN BY:    | KJR        | PROJECT NO.:   | 13078      |
| APPROVED BY: | RK/PCR     | REVISION DATE: | 08-23-2013 |
| FILE NAME:   | SITEPLAN   | SHEET          | 1 OF 1     |
| SURVEY DATE: | 08-15-2013 |                |            |

COPYRIGHT 2013 BY MSE, INC., REPRODUCTION OR TRANSCRIPTION OF ALL OR PART OF THIS DOCUMENT WITHOUT EXPRESS WRITTEN PERMISSION IS PROHIBITED. surveyrequest@meridiansurvey.com